

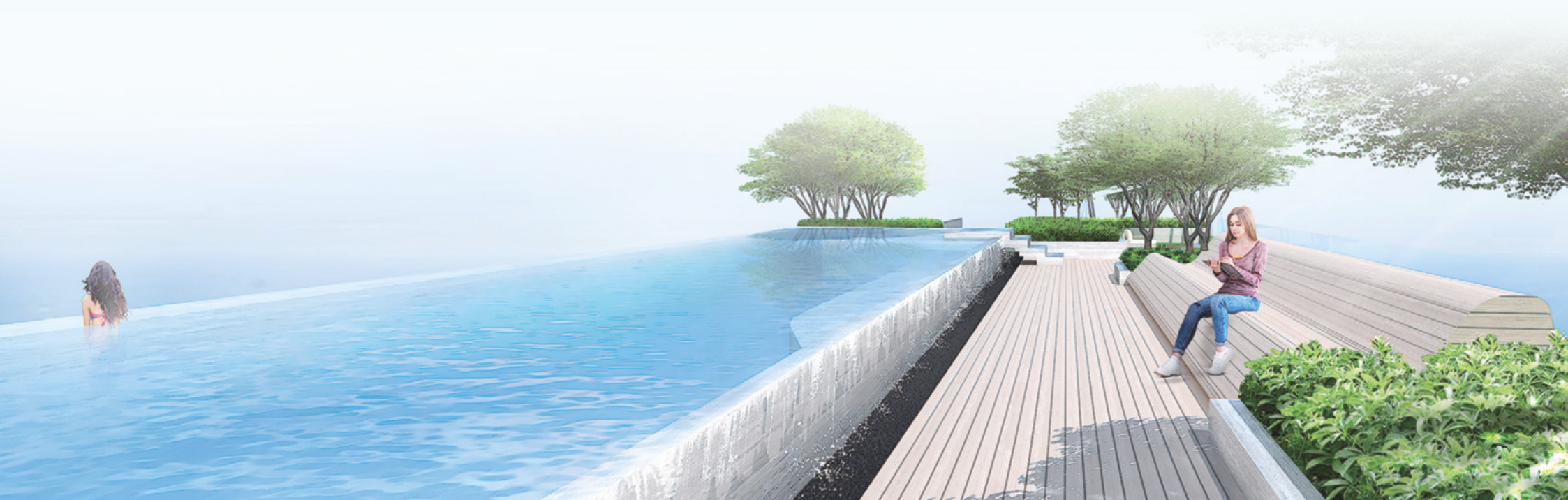

**SKYPARK**





## REACH FOR THE SKY

Nestled within the lush natural landscaping overlooking the verdant Laguna Phuket Golf Course, **SKYPARK** is Laguna's latest residences, offering owners a tranquil place to call home. **SKYPARK** provides residents peace of mind with affordable live-in condominiums that add convenience and style to tropical living.

Residents enjoy exclusive access to leisure facilities on the rooftop, which also offers relaxing areas and doubles as a community meeting space. The development's buildings are linked together with sky bridges, making a large **SKYPARK** surrounded by greenery, lagoon views and glimpses of the ocean. The skypool and unique sky jogging track allow residents and visitors to stay healthy while enjoying the beautiful outdoors.





## PREMIER DESTINATION RESORT

Overlooking the top-tier Laguna Phuket Golf Course, **SKYPARK** occupies a prime location inside Laguna Phuket, Asia's finest integrated resort, and puts homeowners and residents within close proximity of the three-kilometre-long Bang Tao beach. Residents have access to the inter-resort shuttle service to enjoy the facilities of five star resorts and deluxe leisure pursuits within the award-winning complex.

In addition to the choice luxurious spas, upscale resorts, facilities and activities within Laguna Phuket, homeowners are also well placed to make the most of lifestyle attractions such as the nearby Boat Avenue shopping complex and the upcoming Central Porto de Phuket boutique retail and dining complex.





**OVERLOOKING THE TOP-TIER  
LAGUNA PHUKET GOLF COURSE**







## THE SKY IS NOT THE LIMIT

Inspired by the spontaneous pattern of Thai vernacular riverside villages, the development comprises low-rise buildings. The buildings' V-shapes maximise the views over the golf course and feature outdoor functional spaces that extend into the nature surrounding the project. This unique configuration is captured and translated into a contemporary design narrative with a crafted mix of unit designs based on studio, one- and two-bedroom configurations. Further flexibility is also provided with a range of unit fit-outs including basic, fitted with built-in furniture and appliances and fully furnished options. The choice is yours.

Reaching for the sky, the well-planned rooftop facilities allow residents to make the most of the great outdoors and include an infinity-edged pool with Jacuzzi and a unique sky running track. The al fresco social hub also features a large BBQ area, spacious sky deck, yoga space and open, lawned relaxation area with green landscaping and a panoramic view point offering sweeping vistas of the tropical surroundings.





**OFFERING STUDIO,  
ONE AND TWO BEDROOM  
CONFIGURATIONS**







## REWARDING LIFESTYLE

Established over thirty years as Asia's first integrated resort complex, Laguna Phuket has matured into a leading community and contributed to the island's success as a year-round island destination. Whether it's shopping centres, international schools or world class hospitals, residents have all the facilities they need at their fingertips to make their island dream a living reality.

**SKYPARK** caters for both buyers who want a primary or second home or investment property. Professionally managed by Laguna Resorts and Hotels, owners can rest assured that a professional team is always on hand to look after their homes or manage their properties when they are away.







Angsana Riads Collection, Morocco



Cassia Bintan, Indonesia



Banyan Tree Bangkok, Thailand

## WORLDWIDE PRIVILEGES

A world of privileges and rewards awaits all **SKYPARK** homeowners, including complimentary membership of The Sanctuary Club, which offers privileges and discounts across the Banyan Tree network worldwide.



Banyan Tree Lijiang, China







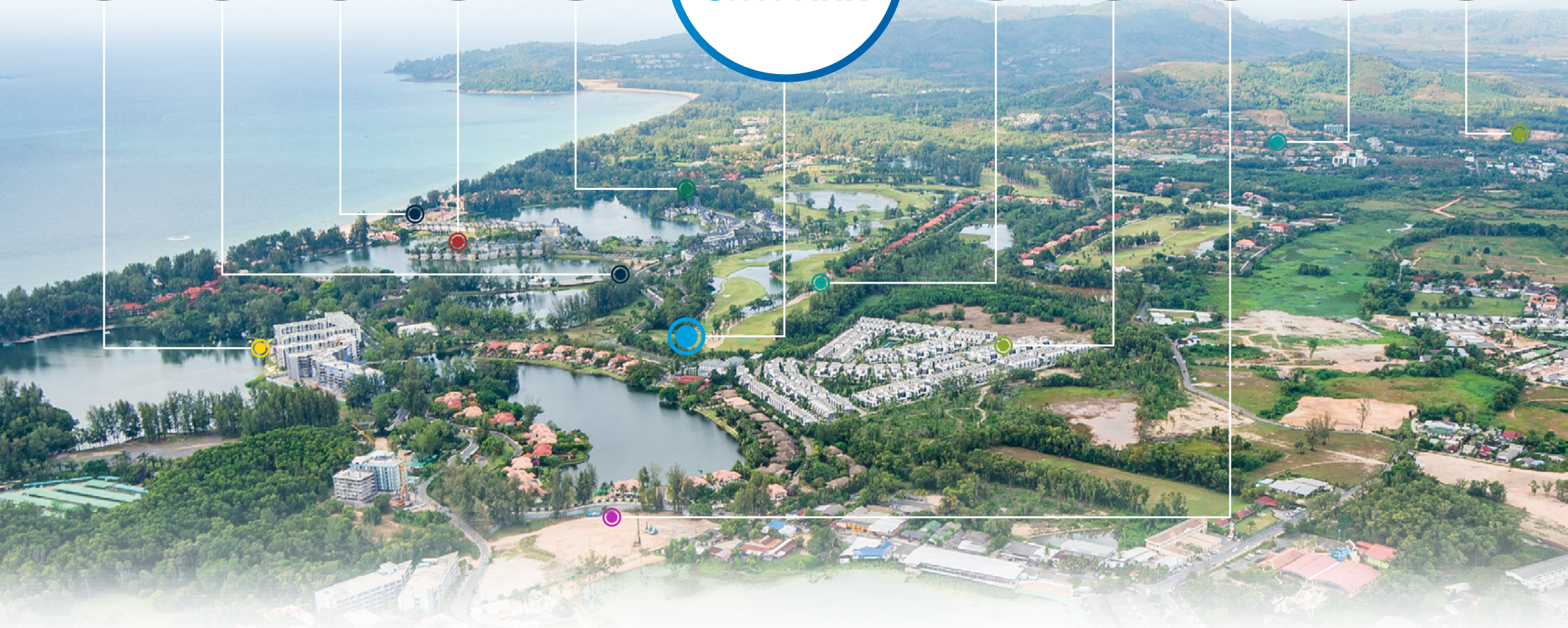



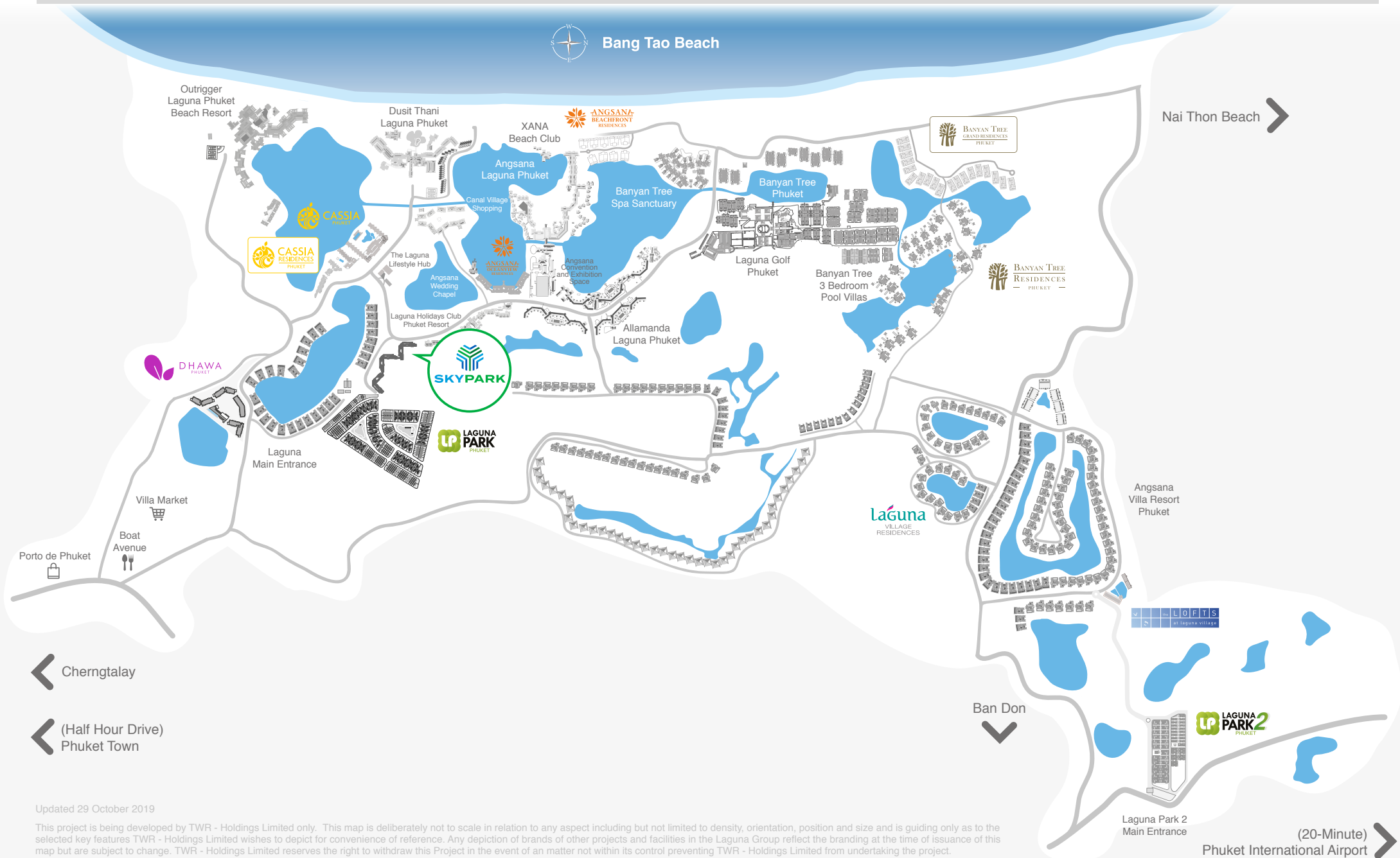

This project is being developed by TWR - Holdings Limited only. This map is deliberately not to scale in relation to any aspect including but not limited to density, orientation, position and size and is guiding only as to the selected key features TWR - Holdings Limited wishes to depict for convenience of reference. Any depiction of brands of other projects and facilities in the Laguna Group reflect the branding at the time of issuance of this map but are subject to change. TWR - Holdings Limited reserves the right to withdraw this Project in the event of a matter not within its control preventing TWR - Holdings Limited from undertaking the project.

(20-Minute)  Phuket International Airport









For more information, please contact the [Property Sales Office](#)

 +66 (0)76 362 333

 [info@lagunaproperty.com](mailto:info@lagunaproperty.com)

 [www.lagunaproperty.com/skypark](http://www.lagunaproperty.com/skypark)

**Disclaimer:** Skypark Project is developed by TWR-Holdings Limited having Mr. Shankar Chandran as the Managing Director. The company has a registered capital of 1,550,000,000 THB, having been fully paid up and registered address at 390/1 Moo 1, Cherngtalay Sub-district, Thalang District, Phuket. The project is on part of land under Chanote number 7344 in Moo 4 of Cherngtalay Sub-district, Thalang District, Phuket with the area of 7 Rai 194.8 Square Wah (7-1-94.8 Rai). It is in process to apply for project financing and construction permit. The construction is estimated to commence in mid 2020 and expected to be completed end of 2024. The project will be used for residence and commerce and registered as the Condominium once the construction is completed. The building shall comprise 7 floors, having a total 416 units. The unit owner has a duty to pay any expense and taxes as required by the Condominium Law. The photos are virtualized design for purpose of advertisement only. TWR-Holdings Limited reserves the right to withdraw this project in the event of a matter not within its control preventing TWR - Holdings Limited from undertaking the project.

Update 24 December 2019