

IDEO
INOBI
SUKHUMVIT EASTPOINT



*SPANNING
ALL DIMENSIONS
OF LIVING*

FACT SHEET

Land Area	7 - 3 - 24.5	Rai
No. of Residential Buildings	1 Building	(2 Tower)
No. of Stories	32	(2 Tower)
No. of Units	1,165	
No. of Residential Units	1,162	
No. of Commercial Units	3	
No. of Residential Units Tower A	520	
No. of Residential Units Tower B	642	
No. of Passenger Elevators Tower A	4	
No. of Passenger Elevators Tower B	4	
No. of Parking Spaces	547	
Tower A: Ground Floor	Lobby, Mailboxes, Commercial Unit	
Level 5	Residential Units, Swimming pool, Laundry room*, Social club	
Level 6-31	Residential Units	
Level 32	Residential Units, Panoramic lounge	
Tower B: Ground Floor	Lobby, Juristic person's office, Mailboxes	
Level 5	Residential Unit, Swimming pool, Laundry room*, Fully equipped gym	
Level 6-32	Residential Units	
	Facilities: Swimming pools, Fully equipped gym, Social Club, Rooftop terrace, Common gardens, Panoramic lounge, Laundry room*, Parking**, CCTV***	

*Laundry equipment not included.

** Generic parking.

*** CCTV cameras are found only at locations specified by the company.

The company reserves the right to amend the details herein without prior notice.

IDEO
INOBI
SUKHUMVIT EASTPOINT

IDEO MOBI SUKHUMVIT EASTPOINT

SPANNING ALL DIMENSIONS OF LIVING

The journey itself is as important as the destination: you will find that accomplishing your goal is more meaningful and rewarding if you take the experiences gained into account. The ideal life is a life of balance, in which all dimensions of living are fulfilled.

Under Ideo Mobi Sukhumvit Eastpoint's "Future-Nature" concept, futuristic technologies are fused together with natural elements to create a design and facilities that span and perfect all of your dimensions of living.

- UNBEATABLE LOCATION IN BANGNA,
ON SUKHUMVIT ROAD **250** m. FROM BTS BANGNA
- NEW '**7.6 M.** EXTENDED FRONT ROOM CONCEPT'
GIVING YOU 'THE MOST LIVABLE UNIT'
- EXTENSIVE FACILITIES, WITH **LONGEST SWIMMING POOL** IN BANGNA ZONE
- INNOVATIVE AND DISTINCTIVE DESIGN OF FUTURE AND NATURE

ideo
MOBi
SUKHUMVIT EASTPOINT

EXTERIOR

**IDEO
NOBi**
SUKHUMVIT EASTPOINT



WIDE FRONT SUKHUMVIT ROAD

**IDEO
MOBI**
SUKHUMVIT EASTPOINT

*Text and images are for advertisement purposes only. The company reserves the right to amend the details specified herein without prior notice.



WIDE FRONT SUKHUMVIT ROAD

*Text and images are for advertisement purposes only. The company reserves the right to amend the details specified herein without prior notice.



IDEO
MOBI

DRAFT

IDEO
MOBI

IDEO
MOBI
SUKHUMVIT EASTPOINT

WIDE FRONT SUKHUMVIT ROAD

*Text and images are for advertisement purposes only. The company reserves the right to amend the details specified herein without prior notice.

HIGH FOREST

**IDEO
NOBI**
SUKHUMVIT EASTPOINT

*Text and images are for advertisement purposes only. The company reserves the right to amend the details specified herein without prior notice.



SWIMMING POOL

*Text and images are for advertisement purposes only. The company reserves the right to amend the details specified herein without prior notice.



SWIMMING POOL

*Text and images are for advertisement purposes only. The company reserves the right to amend the details specified herein without prior notice.

SKY COURTYARD

INTERIOR  **R**

IDEO
NOBi
SUKHUMVIT EASTPOINT



LOBBY SCAPE



CONNECTION SPACE

*Text and images are for advertisement purposes only. The company reserves the right to amend the details specified herein without prior notice.



CONNECTION SPACE

IDEO
MOBI
SUKHUMVIT EASTPOINT



FITNESS

Text and images are for advertisement purposes only. The company reserves the right to amend the details specified herein without prior notice.



FITNESS

IDEO
MOBI
SUKHUMVIT EASTPOINT

*Text and images are for advertisement purposes only. The company reserves the right to amend the details specified herein without prior notice.



PANORAMIC LOUNGE

IDEO
MOBI
SUKHUMVIT EASTPOINT



PANORAMIC LOUNGE



ROOM TYPE A - STUDIO (26 SQ.M.)



ROOM TYPE B - 1 BED (36 SQ.M.)



ROOM TYPE B - 1 BEDROOM (36 SQ.M.)

*Text and images are for advertisement purposes only. The company reserves the right to amend the details specified herein without prior notice.



ROOM TYPE D - 2 BEDROOM (56 SQ.M.)

**IDEO
NOBI**
SUKHUMVIT EASTPOINT



ROOM TYPE D - 2 BEDROOM (56 SQ.M.)

*Text and images are for advertisement purposes only. The company reserves the right to amend the details specified herein without prior notice.



ROOM TYPE E - DUPLEX (50 SQ.M.)



ROOM TYPE E - DUPLEX (50 SQ.M.)

FLOOR PLAN

IDEO
NOBi
SUKHUMVIT EASTPOINT

Ground Floor Plan



Remark : All pictures here are the simulated pictures only for advertisement. The company reserves the right in changing as stated without prior notice.
Style, Furniture Arrangement and proportion allocation including the details are only the presentation of sample of utility space allocation and for the advertising only.

5th Floor Plan



IDEA
MOBI
SUKHUMVIT EASTPOINT



Remark : All pictures here are the simulated pictures only for advertisement. The company reserves the right in changing as stated without prior notice.
Style, Furniture Arrangement and proportion allocation including the details are only the presentation of sample of utility space allocation and for the advertising only.

7th, 9th, 11th, 13th Floor Plan

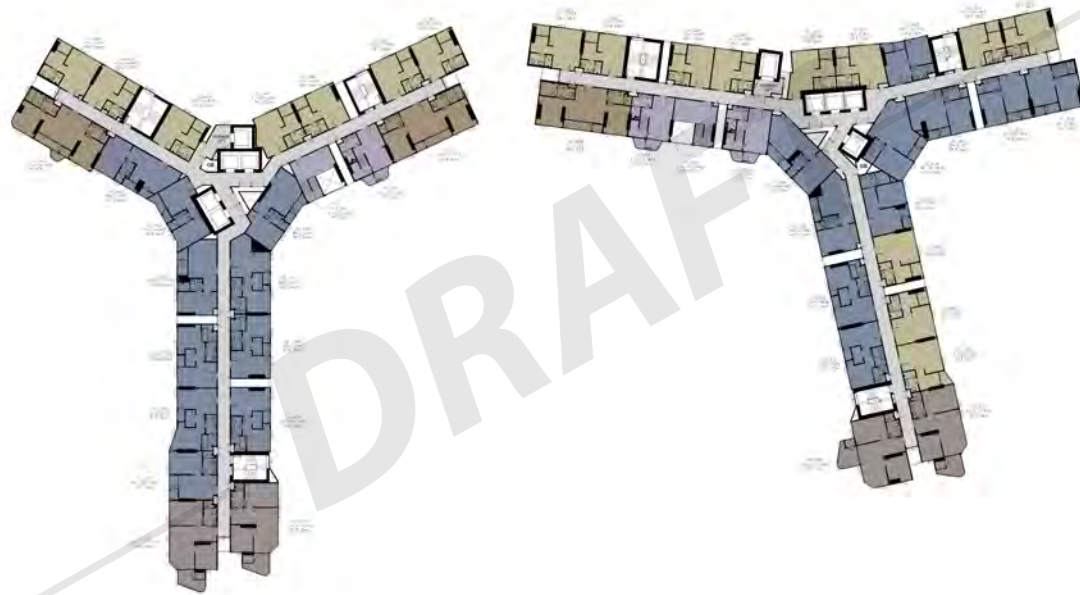

IDEA
NOBI
SUKHUMVIT EASTPOINT



Remark : All pictures here are the simulated pictures only for advertisement. The company reserves the right in changing as stated without prior notice.
Style, Furniture Arrangement and proportion allocation including the details are only the presentation of sample of utility space allocation and for the advertising only.

32nd Floor Plan



IDEO
NOBi
SUKHUMVIT EASTPOINT



Remark : All pictures here are the simulated pictures only for advertisement. The company reserves the right in changing as stated without prior notice.
Style, Furniture Arrangement and proportion allocation including the details are only the presentation of sample of utility space allocation and for the advertising only.

Roof Plan



IDEO
MOBI
SUKHUMVIT EASTPOINT



Remark : All pictures here are the simulated pictures only for advertisement. The company reserves the right in changing as stated without prior notice.
Style, Furniture Arrangement and proportion allocation including the details are only the presentation of sample of utility space allocation and for the advertising only.

UNIT PLAN

IDEO
INOBi
SUKHUMVIT EASTPOINT



STUDIO
26 SQ.M.

IDEO
INOBI
SUKHUMVIT EASTPOINT



1 BEDROOM

36 SQ.M.

IDEO
NOBi
SUKHUMVIT EASTPOINT



2 BEDROOM 1 BATH

54 SQ.M.

IDEA
NOBI
SUKHUMVIT EASTPOINT



2 BEDROOM 2 BATHROOM

56 SQ.M.

IDEA
NOBI
SUKHUMVIT EASTPOINT

Remark : All pictures here are the simulated pictures only for advertisement. The company reserves the right in changing as stated without prior notice.
Style, Furniture Arrangement and proportion allocation including the details are only the presentation of sample of utility space allocation and for the advertising only.



LOWER



UPPER

DUPLEX
50 SQ.M.

IDEO
NOBi
SUKHUMVIT EASTPOINT

Remark : All pictures here are the simulated pictures only for advertisement. The company reserves the right in changing as stated without prior notice.
Style, Furniture Arrangement and proportion allocation including the details are only the presentation of sample of utility space allocation and for the advertising only.

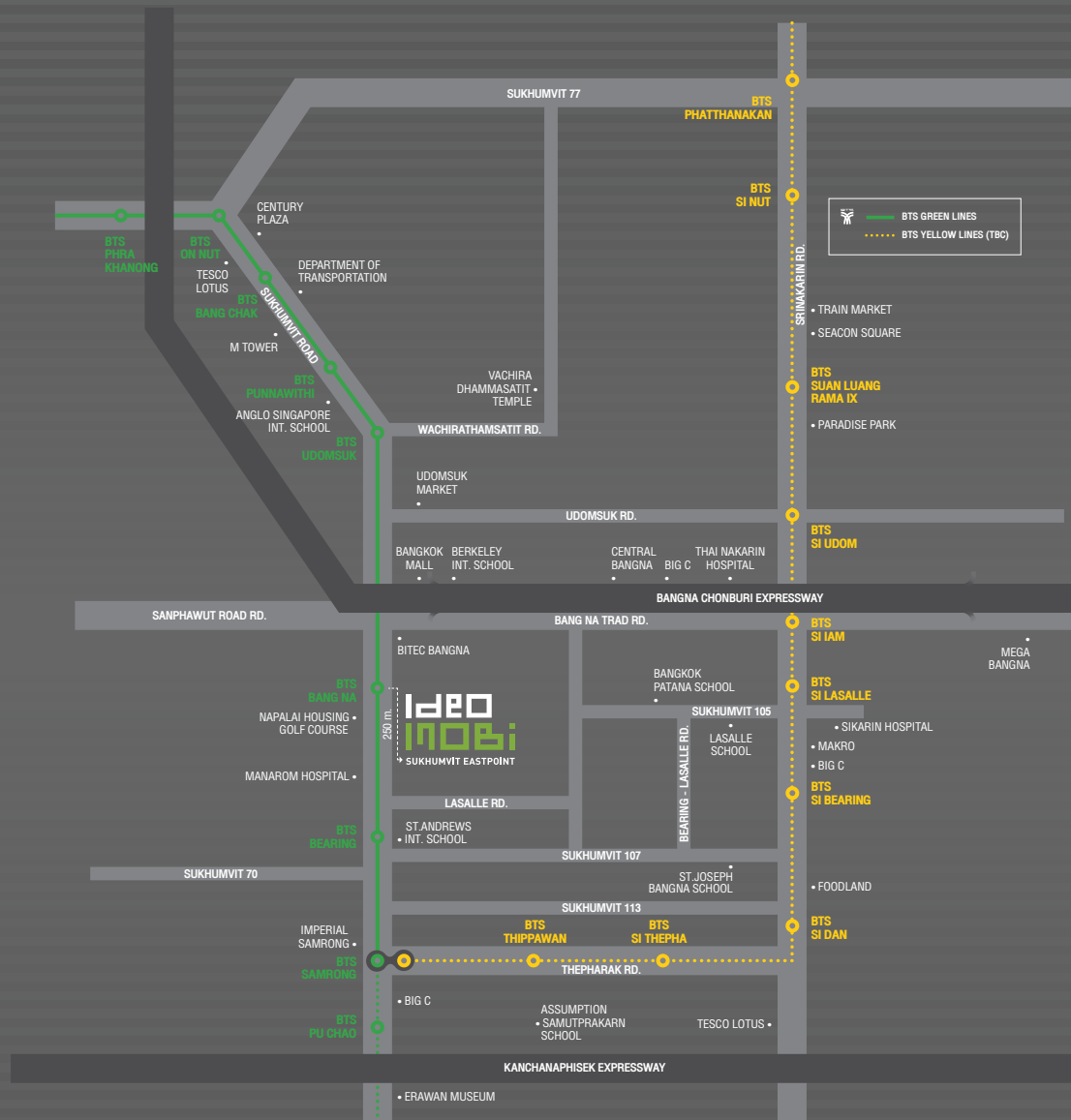

Idea Mobi Sukhumvit Eastpoint Condominium Owner of the project: Ananda MF Asia Bangna Two Company Limited, registered capital 100,000 baht (one hundred thousand baht only) (fully paid-up), head office located at 99/1 Moo 14, Soi Wind Mill Village, Bang Na-Trat Rd. (km 10.5), Bang Phi Yai Sub-District, Bang Phi District, Samut Prakan Province, Managing Director Mr. Chanond Ruangkritya. Built as 32-storey condominium (excluding rooftop). 1 building (2 towers) consists of 1,162 residential units and 3 commercial units, totalling 1,165 units. Common properties include swimming pool, gym and equipment, and green areas. The project is located on Sukhumvit Rd., Bangna Sub-District, Bangna District, Bangkok on the land title deed number 2478, 2482, 2483, 2484, 2485, 2486, 2487 and 2489 Bangna Sub-District, Bangna District, Bangkok. Approximated project area is 7 Rai 3 Ngan and 24.5 square Wa. The land and building has financial encumbrance with Bang of Ayudhya PCL. Currently the construction permit is granted, the construction commenced in August 2018 and expected complete in December 2020, the building will be registered as condominium upon the completion. Unit owners are required by law to pay the condominium transfer fee, as well as other fees pertinent as notified by the seller.